

**TYPE 2 ROUNDABOUT**

**TYPE 1 ROUNDABOUT**

**NOTES**

1. TYPE 1 ROUNDABOUT IS USED FOR:
  - 1.1. ROADS THAT ARE PREDOMINANTLY USED BY HEAVY VEHICLES SUCH AS INDUSTRIAL/COMMERCIAL ESTATES, AND RESIDENTIAL CONNECTOR ROADS
2. TYPE 2 ROUNDABOUT IS USED FOR ROADS OTHER THAN NOTE 1.
3. SM3 KERB TO BE CONSTRUCTED AS PER EDMC 302.
4. CONCRETE STRENGTH TO BE N32.
5. LANDSCAPED TREATMENTS ACCEPTED IN CENTRAL ISLAND OF ROUNDABOUT:
  - 5.1. VEGETATED – IN ACCORDANCE WITH "LANDSCAPE GUIDELINES FOR THE CITY OF MELTON"
  - 5.2. PAVED – AS PER DETAIL 1
6. RELEVANT SIGNAGE MUST BE INSTALLED AT THE ROUNDABOUT AS PER AS 1742.2.

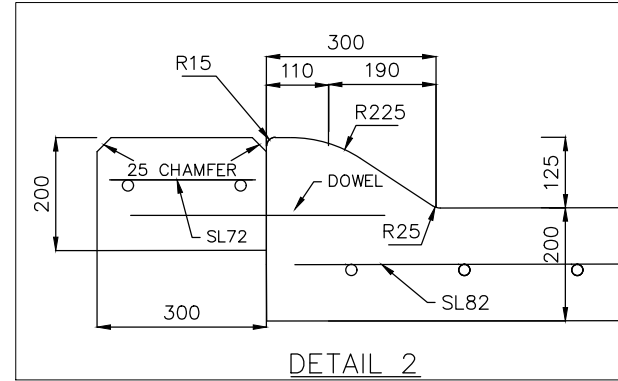

**DETAIL 2**

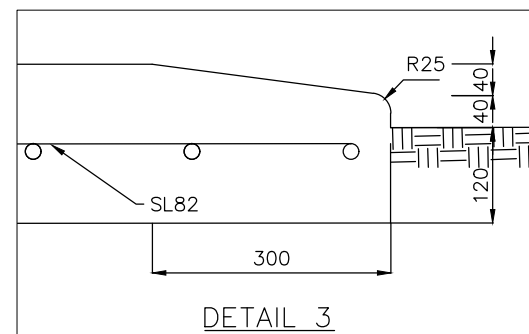

**DETAIL 3**

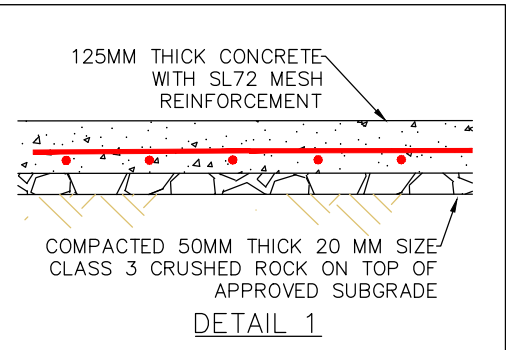

**DETAIL 1**

ISSUE	APPD	DATE	AMENDMENT
E			
D			
C	L.S	09/23	UPDATED STEEL REINFORCEMENT
B	M.H.	05/16	REVIEWED AND UPDATED DESIGN
A	V.C.D	01/09	INITIAL DESIGN

GENERAL NOTES



DESIGN	L.SHE
DRAWN	L.SHE
CHECKED	M.HUTCHINSON
DATE	APRIL 2016

PROJECT  
**STANDARD DRAWING - MCC 203**

DETAILS  
ROUNDABOUT CENTRAL ISLAND

N.T.S.	
SHEET 1 OF 1	PAPER A4
DRAWING No.	REV C
FILE NAME MCC 203 - ROUNDABOUT CENTRAL ISLAND.DWG	

4/9/2023 4:51:00 PM