

DATE: FEBRUARY 18  
SCALE: 1:100  
SITE & FLOOR PLAN

OWNER: DEJAN FILIPOSKI  
LOCATION: No. 15 EMPRESS WAY, MELTON SOUTH

PLANS PROVIDED BY:  
A.R.E. Design & Drafting  
Email: office@aredesign.com.au  
Web: www.aredesign.com.au

MODEL:  
No. 15  
Date: No. 15/07/17  
SHEET 3 OF 3

Legend provided to Council  
at 08/07/2018  
20/07/2018

Note: All levels to AHD

T.B.M. RIVET  
IN TOP OF KERB  
R.L. 139.27(AHD)

| Unit   | Ground Floor         | First Floor          | Total                            | Total (Building)                 |
|--------|----------------------|----------------------|----------------------------------|----------------------------------|
| Unit 1 | 75.62 m <sup>2</sup> | 59.52 m <sup>2</sup> | 135.14 m <sup>2</sup> (14.55 sq) | 183.83 m <sup>2</sup> (17.64 sq) |
| Unit 2 | 67.87 m <sup>2</sup> | 48.62 m <sup>2</sup> | 116.49 m <sup>2</sup> (12.54 sq) | 146.40 m <sup>2</sup> (13.79 sq) |
| Unit 3 | 66.52 m <sup>2</sup> | 53.05 m <sup>2</sup> | 119.57 m <sup>2</sup> (13.34 sq) | 155.62 m <sup>2</sup> (14.79 sq) |
| Unit 4 | 67.93 m <sup>2</sup> | 48.74 m <sup>2</sup> | 116.67 m <sup>2</sup> (12.56 sq) | 143.05 m <sup>2</sup> (13.40 sq) |



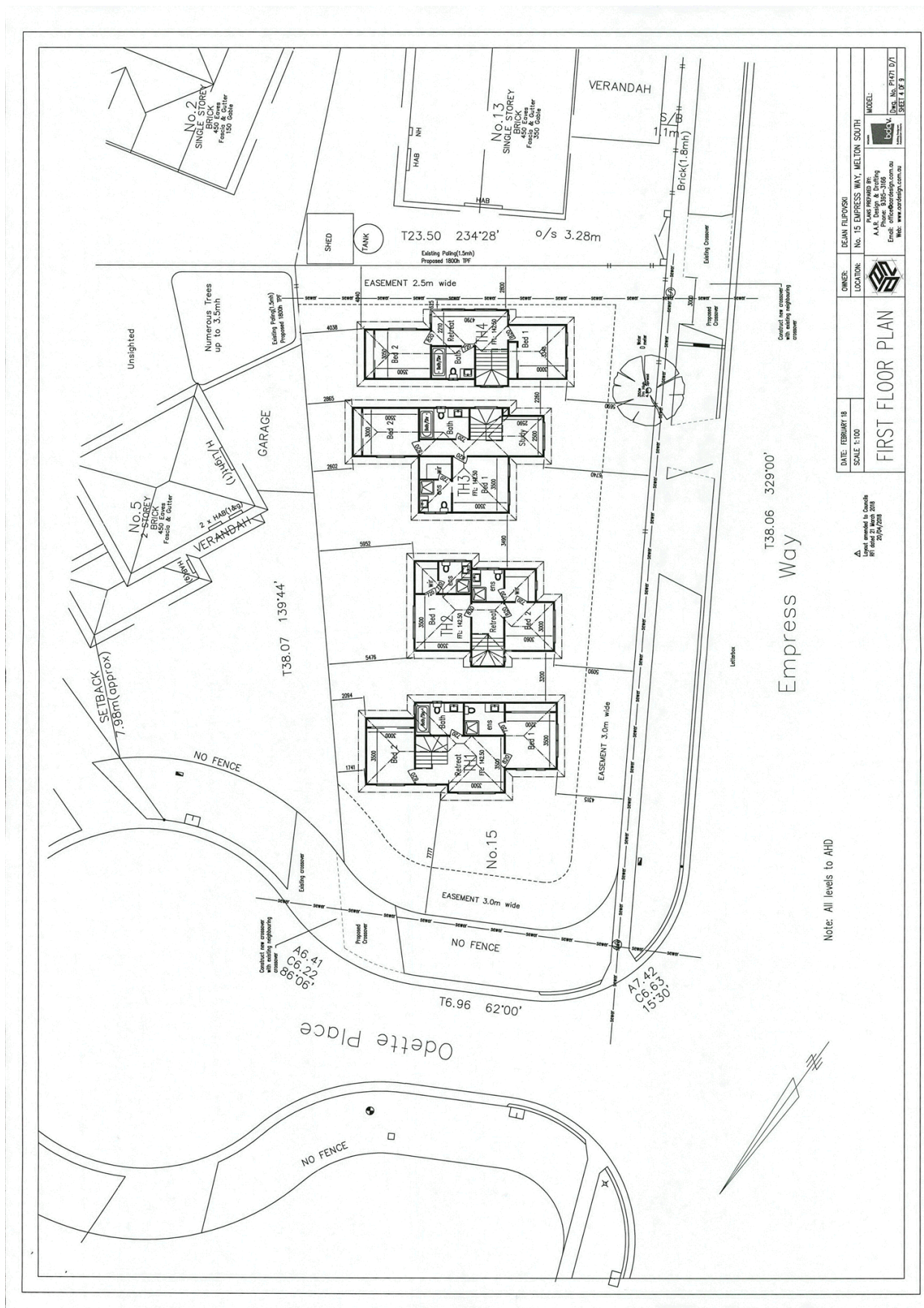

|                         |                                  |
|-------------------------|----------------------------------|
| OWNER:                  | DEJAN FILIPOVSKI                 |
| LOCATION:               | No. 15 EMPRESS WAY, MELTON SOUTH |
| DATE:                   | FEBRUARY 18                      |
| SCALE:                  | 1:100                            |
| <b>FIRST FLOOR PLAN</b> |                                  |

Level amended to coincide with AHD  
 20/02/2018

OWNER: DEJAN FILIPOVSKI  
 LOCATION: No. 15 EMPRESS WAY, MELTON SOUTH  
 DRAWN BY: A.R. Design & Drafting  
 Email: office@ardesign.com.au  
 Web: www.ardesign.com.au  
 MODEL: 10000  
 Date: No. P1471 D/1  
 SHEET 1 OF 3

Note: All levels to AHD







